

Sonofresco Coffee Roaster

Control Board Replacement Instructions

Please read these instructions before attempting to replace the electronic control board. Failure to do so may cause damage to the control board not covered by warranty.

- DISCONNECT APPLIANCE FROM ELECTRICAL POWER SOURCE BEFORE PERFORMING ANY WORK.
- DISCONNECT APPLIANCE FROM GAS SUPPLY BEFORE PERFORMING ANY WORK.

Failure to follow precautions may lead to electrical shock.



Fig. 1

Suggested Tools:

- #2 Phillips screwdriver (Phillips bit mounted in a drill works best).

Remove six (6) brass screws from chrome top plate using Phillips screwdriver.



Fig. 3

Insert proper voltage jumper.

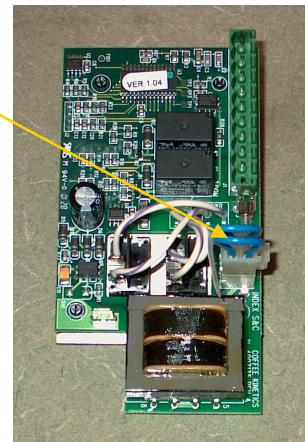

Fig. 2

- Remove two (2) screws to disconnect the control board.
- The control board will not be removed from wiring harness.

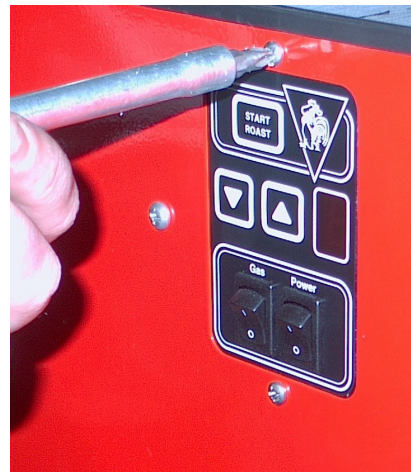

Fig. 4

Important:

The new control board is arranged differently than previous versions and must be installed correctly (see illustrations). Failure to do so will result in damage not covered under the warranty. The 10-pin wire harness connector must be turned 180 degrees and installed as shown in fig. 7. Additionally, the ground wire now plugs in to the lower portion of the control board.

Note: Old version control boards should only exist on one pound roasters with serial numbers lower than CK-3100.

Old
version

Version 1.00—1.03

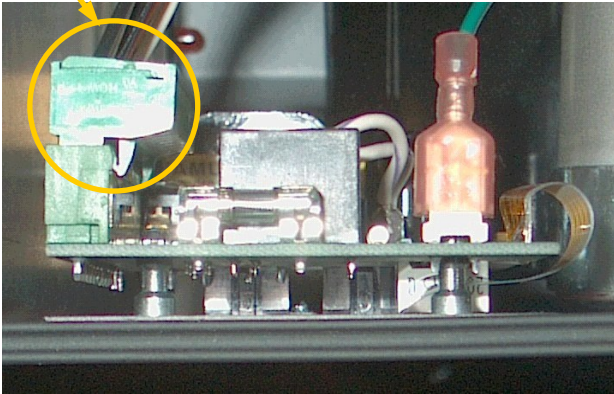

Fig. 5

(Control Board Viewed From the

Note:

The 10 pin connector on the version 1.04 to current control board is installed by turning the connector 180° as seen in fig. 2. **DO NOT PLUG THE CONNECTOR IN BACKWARDS.**

Version
Label

Rounded Scallop

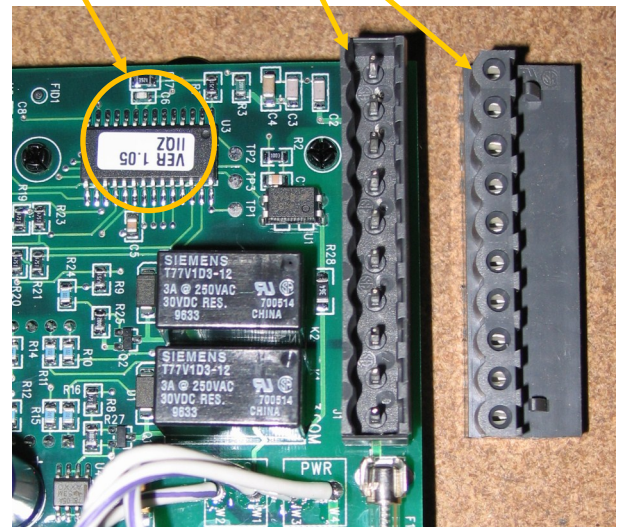

Fig. 6

Ensure the scallops on connector match to the scallops on the control board (rounded to rounded and squared to squared).

The connector should appear,
when viewed from the top, if in-
stalled correctly (as shown in fig.

Version 1.04—onward

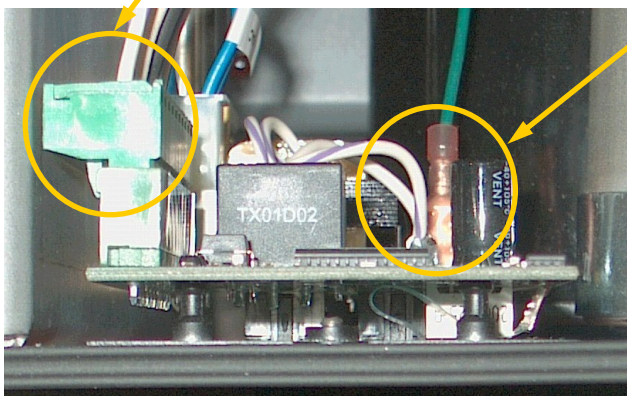

Fig. 7

(Control Board Viewed From the

The ground wire plugs into

Reassemble roaster in the opposite order after control board replacement.